

p855 860-860-003A / P855.TIF

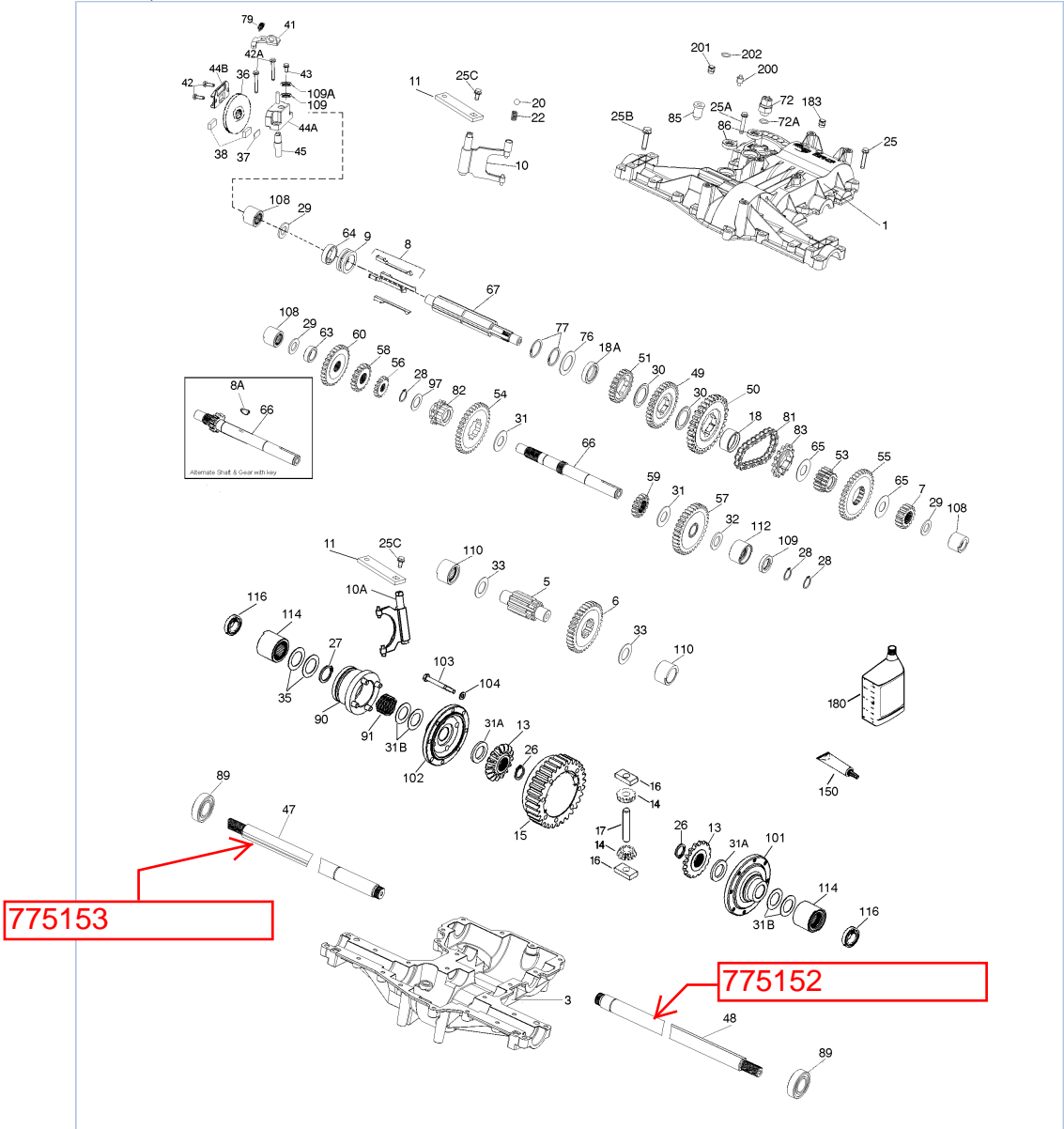

Part List

p855 860-860-003A / P855.TIF

REF #	ITEM #	DESCRIPTION	QTY	REMARK
6	778247	Output Gear 35T STL	1	
202	788117	O RING		
97	780051	Thrust Washer (.762 ID X .031W)	2	
117	780031	Needle Bearing	1	
114	786152A	Sleeve Assy. (incl. bearing & seal)	2	
31A	780107	Flat Washer .877 ID .141W	2	
16	786027	Drive Block	1	
17	786019	Drive Pin	1	
27	792113	RET RING	1	
31B	780042	Thrust Washer .877 ID - .031W	2	
78	780066	Bushing	1	
106	786144	Sleeve	1	
108	780150	Needle Bearing	1	
49	778256A	Spur Gear 27T STL IC	1	
58	778257	Spur Gear 23T STL SER	1	
89	780050	Ball Bearing .9995 ID	2	
83	786124	Sprocket 14T PM	1	
65	780165	Thrust Washer .752 ID - .031W	2	
25B	792129A	Screw, 5/16-18 x 1-3/8"	4	
32	792115	Flat Washer .755 ID - .105W	1	
28	788038	RET RING	3	
31	780128	Thrust Washer .877 ID - .058W	2	
3	770145	Transaxle Case	1	
5	776275	Output Shaft	1	
7	778253	Spur Gear 15T STL SER	1	
8	792223	SHIFT KEY SET (QTY. 2 per pkg)	1	
9	784352	Shift Collar	1	
10A	784375	Shift Rod & Fork	1	
10	784391	Shift Rod & Fork	1	
11	784393	Shift Lever	2	
13	778198	BEVEL GEAR 16T STL	2	
14	778197	Bevel Pinion Gear 10T STL	2	
15	778248	Ring Gear 31T	1	
18	786102	Neutral Spacer (1.130 X .695)	1	
20	792105	Steel Ball - 3/8"	1	
22	792142	Spring	1	
25	792073A	Screw, 1/4-20 x 1-1/4"	18	
26	792018	RETAINING RING .750 X .078 EXT	2	
29A	780007	Thrust Washer 1.002 ID	2	
30	780108	Shift (Cup) Washer	2	
31	780001	Washer .750 ID .56W	2	
29	780065	Thrust Washer .627 ID .091W	3	
39	786026	Dowel Pin .3125 x .750	4	
50	778206A	SPUR GEAR 35T STL IC	1	
51	778219	Spur Gear 20T STL IC	1	
53	778398	Gear & Bushing Assy (15T STL)	1	
54	778395	SPUR GEAR 35T STL	1	
55	778394	SPUR GEAR 35T STL	1	
56	778199	Spur Gear 15T STL SER	1	
57	778396	Gear & Bearing Assy. (35T STL)	1	
59	778397	Spur Gear 15T STL SER	1	
60	778222	Spur Gear 30T STL SER	1	
66	776471	Input Shaft	1	
67	776470	Shifter Shaft (4-key slots)	1	
72	786193	NEUTRAL SWITCH	1	
72A	788098	O-ring (.489 ID)	1	
73	780140	Needle Bearing (.750 ID)	1	
77	788078A	Retaining Ring (1.125 X .050 EXT)	2	
81	786062A	Roller Chain (No. 41 chain, 22 links)	1	
82	786213	Sprocket & Bushing Assy	1	
85	792182	Plug	1	
87	788008	Oil Seal 1"	1	
87A	788034	Oil Seal 1/2"	2	
90	786215	Differential Disconnect Collar	1	
91	792226	Spring	1	
101	774833	Differential Carrier	1	
102	774834	Differential Carrier UTV	1	
103	792020	Screw, 1/4-20 x 2-1/4"	8	
25C	792193	Screw, 1/4-28 x .490	2	
104	27513	Lock Washer .218 ID	8	
108	786212	Sleeve Assy. (incl. bearing)	3	
110	786142	Sleeve	1	

110	786211	Sleeve Assy. (incl. bearing)	2	
112	780168	Needle Bearing	1	
112	786214	Sleeve Assy. (incl. bearing)	1	
150	788093A	Liquid Gasket RTV Silicon	1	
109	788088A	Oil Seal 3/4" ID	1	
180	730229B	Gear Oil 80W90 (32 oz.)	1	
183	792118	Pressure Relief Fitting (1-5 PSI)	1	
76	780145	Thrust Washer	1	
25A	792177	Screw, 1/4-20 x 1-3/8"	2	
200	792228	Lock Out Pin	1	
201	792229	Plug (Plastic #2 SAE)	3	